

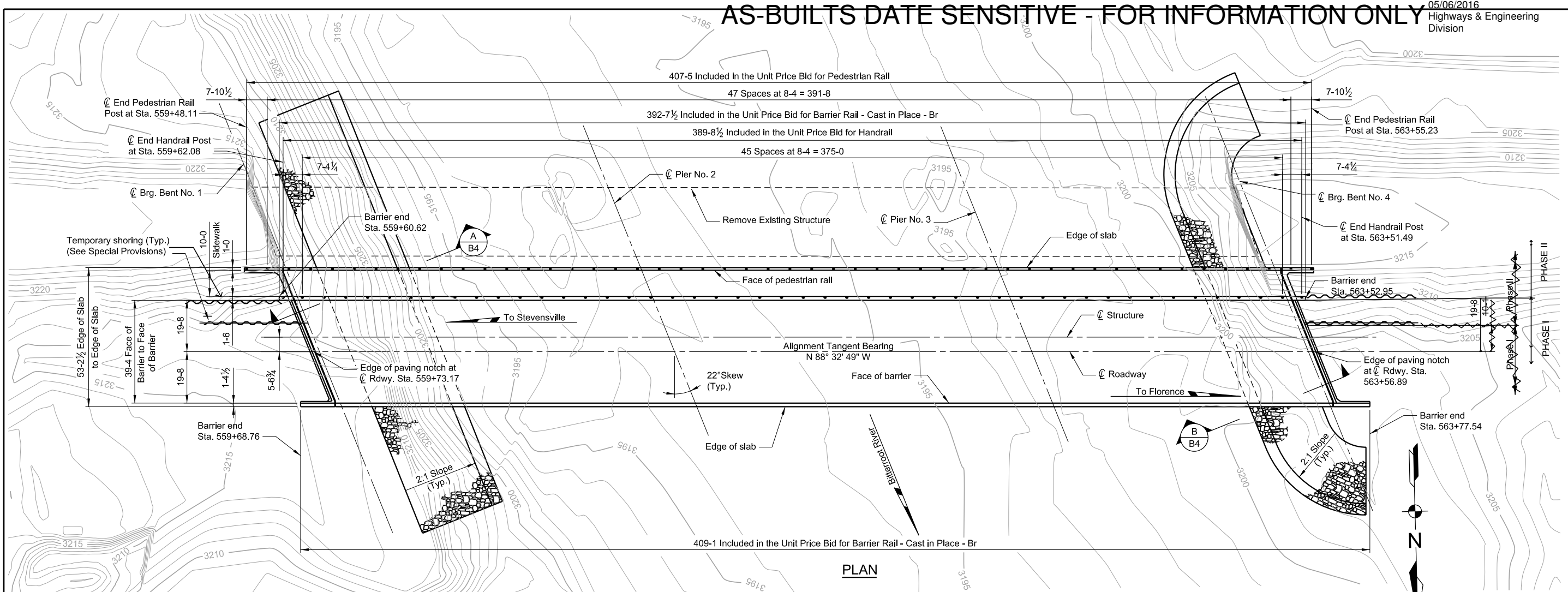

**ENGINEERING CONSTRUCTION CONTRACTING SECTION
MONTANA DEPARTMENT OF TRANSPORTATION**

As-Built Drawings

The following are as-built drawings for the structures. MDT provides them for informational purposes only. They do not include drawings for modifications to the structures, such as joint replacements and guardrail revisions and may not completely represent current conditions. Thus, some of the information contained in these documents may be out of date or not applicable with regard to the advertised project. The contractor should not rely solely on the as-built drawings provided for bidding purposes nor does any data in these files supersede the data in the contract documents.



NOTE: Slab is continuous over intermediate piers (See Std. Dwg. No. SL-8 and Dwg. No. 21691).

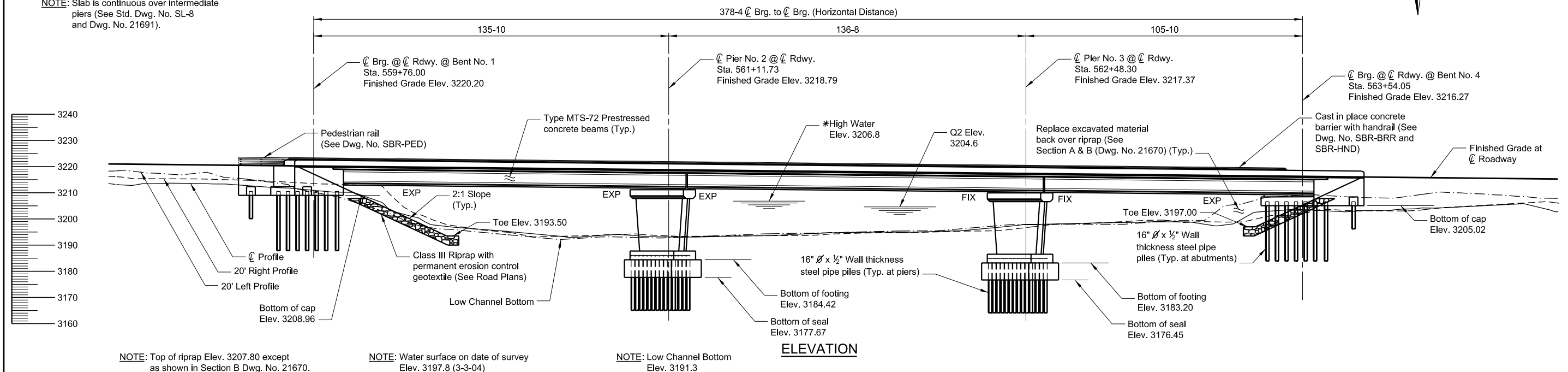

NOTE: Top of riprap Elev. 3207.80 except
as shown in Section B Dwg. No. 21670.

NOTE: Water surface on date of survey
Elev. 3197.8 (3-3-04)

NOTE: Low Channel Bottom
Elev. 3191.3

NOTE: See Dwg. No. 21670 for Hydraulic Data,
Profile Grade, & Notes.